

Double-Wiper / Bulb-Seal System

In addition to manufacturing slide-out mechanisms, we also provide the devices needed to seal the room from the outside elements.

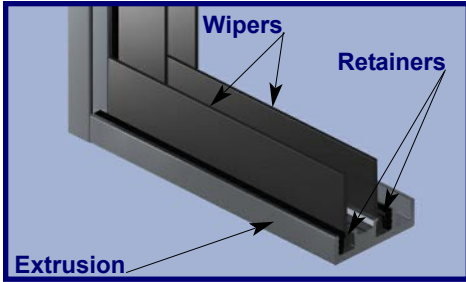

Double-Wiper Assembly
typically mounted to slide-out opening

Our “Double-Wiper” and “Bulb-Seal” assemblies are designed to work together to provide a durable, positive, clean seal.

Components are sold separately, for a cost effective sealing solution.

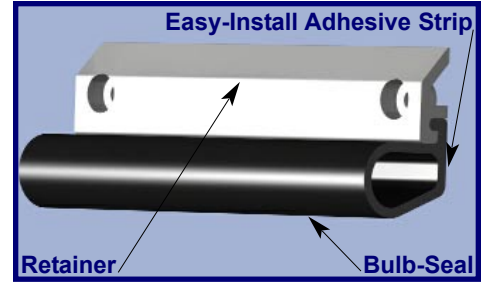

Bulb-Seal Assembly
typically mounted to slide-out itself

DOUBLE-WIPER ASSEMBLY (Patent #7,380,854)

COMPONENTS: Assembly consists of **two rubber wipers** mounted on an aluminum **extrusion**. Each wiper is held securely in place by a **retainer**.

FUNCTION: Designed to **wipe off water and debris** from the slide-out as it extends & retracts, providing a **clean seal** as the room moves. Protects against debris getting trapped between seal & structure.

MOUNTING: Designed to be mounted to the entire perimeter of the **slide-out opening**.

PACKAGING: **Wipers:** Available in 1.25” seal gap. Sold by the foot. **Extrusions:** Sold in lengths ranging from 6.5’ to 14’. **Retainers:** Sold by the foot.

Unique Features...

NO CORNER GAPS: Our unique wiper system overlaps (and intertwines) at the corners. This allows wipers to conform to the room corners, trapping water & debris out. “Other” sealing systems leave gaps, allowing water and debris to filter through.

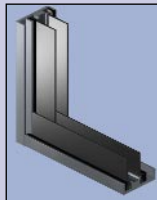

DOUBLE WIPERS: Double wipers bend in the direction of the slide-out movement, giving a cleaner sweep.

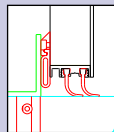

BULB-SEAL ASSEMBLY (Patent #7,419,202)

COMPONENTS: Assembly consists of a **rubber bulb-seal** held securely in place (and protected) by a narrow, low-friction polyethylene **retainer**.

FUNCTION: Designed to create a **positive seal** while the slide-out is extended (out). Bulb-seal **protects the coach interior** from the elements while the seal retainer **protects the seal** from damage.

MOUNTING: Can be mounted to the entire perimeter of the **slide-out opening** or to the **slide-out itself**.

PACKAGING: **Bulb-Seal:** Sold by the foot. **Retainer:** Sold in 18 inch lengths.

Unique Features...

DAMAGE PROTECTION: **Bulb-seal** provides a positive seal between fixed & movable structure while the **retainer** limits the compression of the seal to prevent seal damage. (*Retainer thickness is greater than bulb-seal thickness when seal is fully compressed.*)

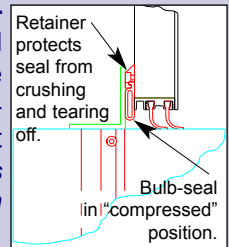

EASY-INSTALL SEAL: Bulb-seals have a convenient adhesive strip backing for convenient installation.

You might also be interested in our Sweepee® & Air Seal for slide-out rooms. Check out our web site to learn more.

Please contact sales at HWH for more information or a sample seal.



(On I-80, Exit 267 South) 2096 Moscow Road | Moscow, Iowa 52760
Phone: (800)321-3494 or (563)724-3396 | Fax: (563)724-3408 | Web: www.HWH.com

Made in the USA



www.hwh.com/ml36951c.wmv

STRONG, RELIABLE, HYDRAULIC POWER