

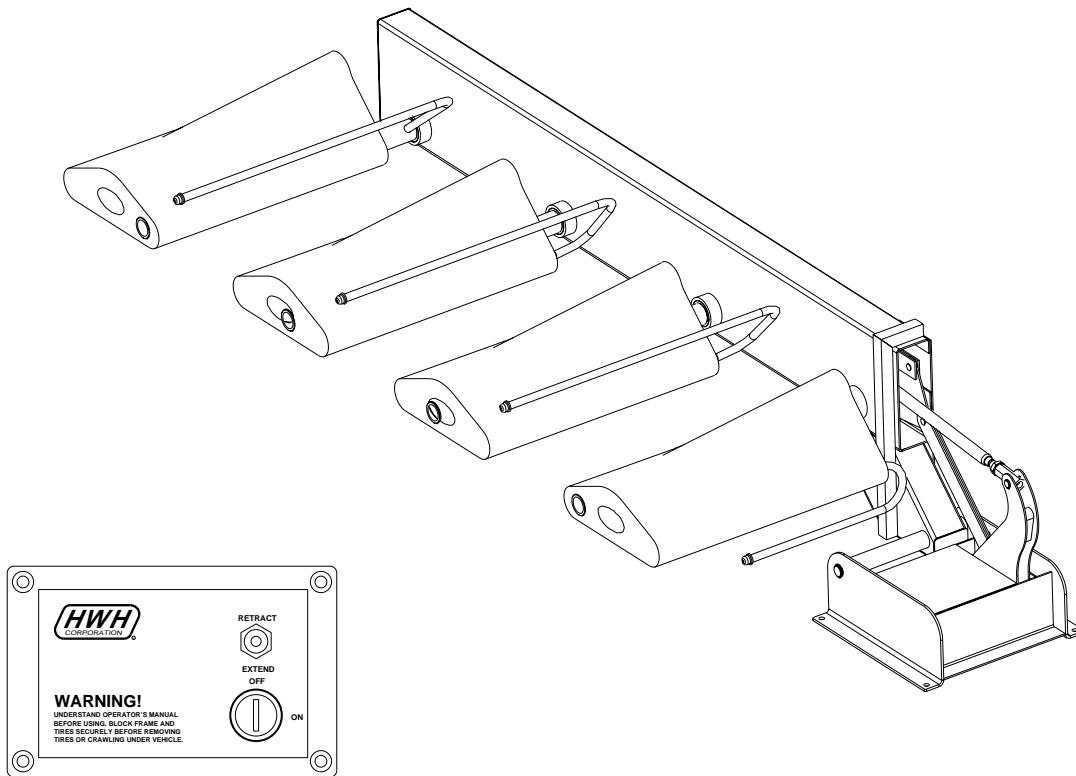

OPERATOR'S MANUAL

HWH® HYDRAULIC SADDLE RACK



HWH CORPORATION
(On I-80, Exit 267 South)
2096 Moscow Road | Moscow, Iowa 52760
Ph: 800/321-3494 (or) 563/724-3396 | Fax: 563/724-3408
www.hwh.com

AP45708

ML45707/MP04.0290
29DEC09

OPERATOR'S MANUAL

WARNING

READ THE ENTIRE OPERATOR'S MANUAL BEFORE OPERATING.

READ OPERATOR'S MANUAL BEFORE OPERATING SADDLE RACK.

KEEP ALL PEOPLE, AND OBJECTS CLEAR OF SADDLE RACK BEFORE OPERATING. DO NOT RIDE ON SADDLE RACK.

STOW RACK BEFORE LOADING OR UNLOADING HORSES.

DO NOT USE SADDLE RACK AS A HITCHING POST.

NEVER PLACE HANDS OR OTHER PARTS OF THE BODY NEAR HYDRAULIC LEAKS. OIL MAY PENETRATE SKIN CAUSING INJURY OR DEATH.

WEAR SAFETY GLASSES WHEN INSPECTING OR SERVICING THE SYSTEM TO PROTECT EYES FROM DIRT, METAL CHIPS, OIL LEAKS, ETC. FOLLOW ALL OTHER APPLICABLE SHOP SAFETY PRACTICES.

HOW TO OBTAIN WARRANTY SERVICE

THIS IS NOT TO BE INTERPRETED AS A STATEMENT OF WARRANTY

HWH CORPORATION strives to maintain the highest level of customer satisfaction. Therefore, if you discover a defect or problem, please do the following:

FIRST: Notify the dealership where you purchased the vehicle or had the leveling system installed. Dealership management people are in the best position to resolve the problem quickly. If the dealer has difficulty solving the problem, he should immediately contact the Customer Service Department, at HWH CORPORATION.

SECOND: If your dealer cannot or will not solve the problem, notify the Customer Service Department:
HWH CORPORATION 2096 Moscow Rd. Moscow IA. 52760
(563) 724-3396 OR (800) 321-3494. Give your name and address, coach manufacturer and model year, date the coach was purchased, or the date of system installation,

description of the problem, and where you can be reached during business hours (8:00 a.m. till 5:00 p.m. c.s.t.). HWH CORPORATION personnel will contact you to determine whether or not your claim is valid. If it is, HWH CORPORATION will authorize repair or replacement of the defective part, either by appointment at the factory or by the authorization of an independent service facility, to be determined by HWH CORPORATION. All warranty repairs must be performed by an independent service facility authorized by HWH CORPORATION, or at the HWH CORPORATION factory, unless prior written approval has been obtained from proper HWH CORPORATION personnel.

CONTROL IDENTIFICATION

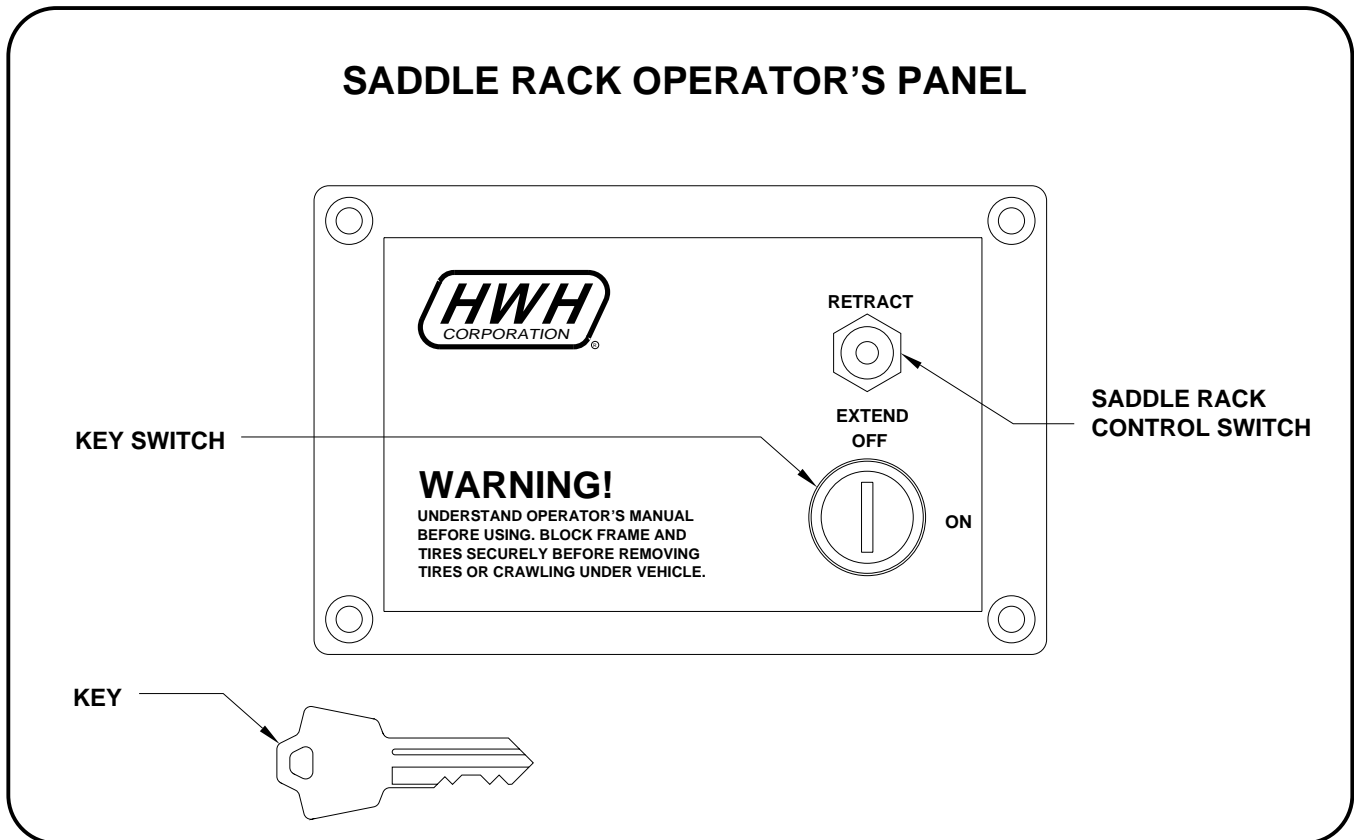

CONTROL FUNCTIONS

KEY SWITCH: The key switch controls power to the saddle rack control switch. The key must be switched to the "ON" position to lower or raise the saddle rack. When the key is in the "OFF" position, the key can be removed to prevent unwanted operation of the saddle rack.

SADDLE RACK CONTROL SWITCH: The saddle rack control switch is a two position momentary toggle switch. Pushing the switch in the "EXTEND" position will lower the saddle rack. Pushing the switch in the "RETRACT" position will raise the saddle rack. Releasing the switch will halt operation of the saddle rack.

OPERATING INSTRUCTIONS

SADDLE RACK

GENERAL INSTRUCTIONS

Maintain adequate clearance to lower the saddle rack without contacting any obstructions.

WARNING: The saddle rack should not be used as a hitching post.

WARNING: STOW SADDLE RACK BEFORE LOADING AND UNLOADING HORSES.

LOWERING SADDLE RACK

WARNING: KEEP ALL PEOPLE AND OBJECTS CLEAR OF SADDLE RACK WHEN OPERATING. DO NOT RIDE ON SADDLE RACK.

NOTE: Make sure there is adequate room to fully lower the saddle rack.

1. Turn the panel key switch to the "ON" position.
2. To lower the saddle rack, push and hold the control toggle switch to the "EXTEND" position until the saddle rack is fully lowered.

NOTE: Releasing the control toggle switch will halt the operation of the saddle rack.

IMPORTANT: Do not hold the control toggle switch in the "EXTEND" position for more than 10 seconds after the saddle rack is fully lowered. If the saddle rack stops moving before fully lowered, release the control toggle switch immediately.

3. Turn the key switch to the "OFF" position and remove the key to prevent unwanted operation of the saddle rack.

STOWING (RAISING) SADDLE RACK

WARNING: KEEP ALL PEOPLE AND OBJECTS CLEAR OF SADDLE RACK WHEN OPERATING. DO NOT RIDE ON SADDLE RACK.

1. Turn the panel key switch to the "ON" position.
2. To stow (raise) the saddle rack, push and hold the control toggle switch to the "RETRACT" position until the saddle rack is fully stowed.

NOTE: Releasing the control toggle switch will halt the operation of the saddle rack.

IMPORTANT: Do not hold the control toggle switch in the "RETRACT" position for more than 10 seconds after the saddle rack is fully stowed. If the saddle rack stops moving before fully stowed, release the control toggle switch immediately.

3. Turn the key switch to the "OFF" position and remove the key to prevent unwanted operation of the saddle rack.

OPERATING PROCEDURES

MANUAL SADDLE RACK STOW PROCEDURE

In the case of an electrical or pump failure, the saddle rack can be pushed up into the stowed position.

1. Clean around the breather cap and remove the breather cap. Be careful to not get any dirt or other contaminants in the reservoir.
2. Place the by-pass tube into the reservoir.
3. Turn the T-handle two complete turns counter-clockwise. Do NOT remove the T-handle from the by-pass block.

NOTE: Some oil may seep out of the T-handle threads when the T-handle is open. This does not indicate a problem.

4. Lift the saddle rack into the fully stowed position.
5. Turn the T-handle clockwise to close the by-pass block. Make sure the T-handle is tight.
6. Remove the by-pass tube from the reservoir and replace the breather cap.

The saddle rack should be serviced before trying to operate it again. Call HWH Customer Support at 1-800-321-3494 or 563-724-3396 for assistance.

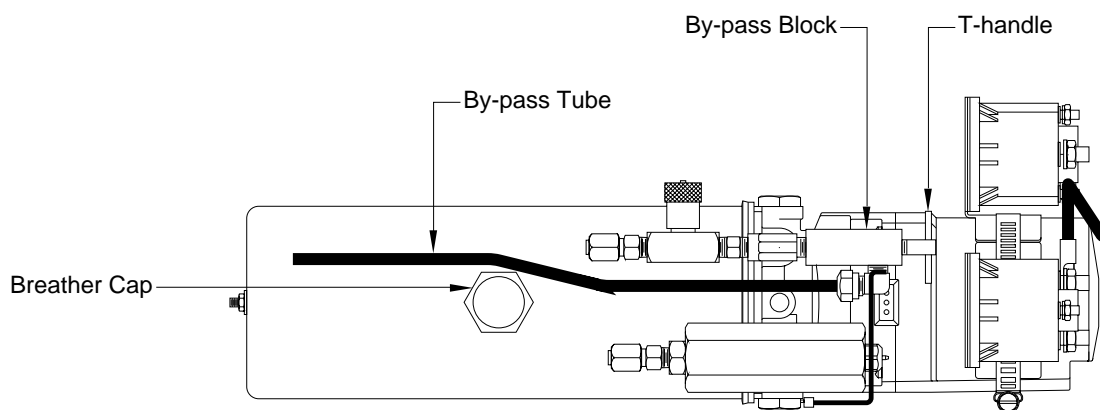

TOP VIEW OF PUMP

HYDRAULIC CONNECTION DIAGRAM

SINGLE CYLINDER SADDLE RACK

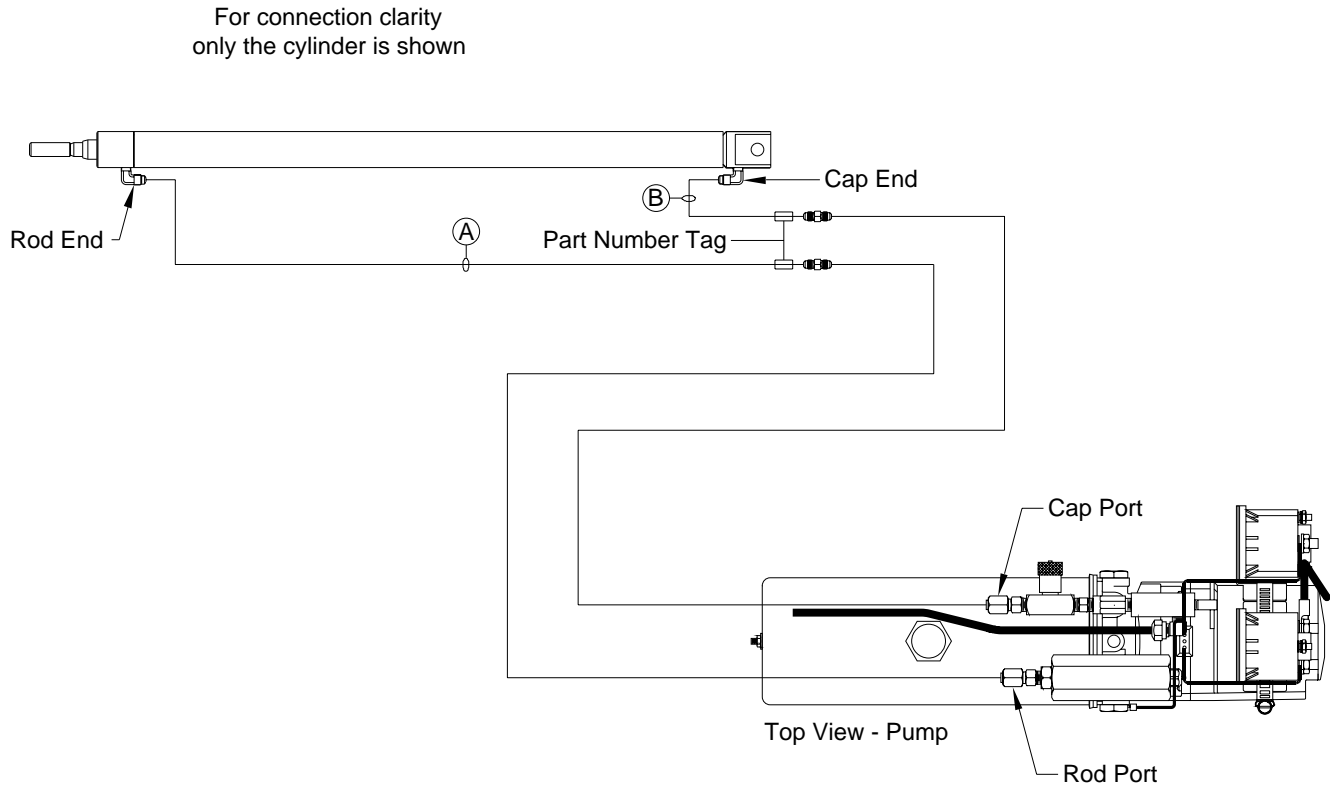

The part number for hose A is AP24637. This hose connects to the rod port.
The part number for hose B is AP24636. This hose connects to the cap port.

Hoses A and B can connect directly to the pump fittings but there can be hoses between the saddle rack mechanism and the pump fittings. Make sure hoses are properly connected to the pump fittings.

Tighten all new hose connections finger tight (snug) plus 2 flats or 1/3 of a turn. When re-tightening existing hose connections, make the connection finger tight plus 1 and 1/2 flats, approximately 1/4 turn.

ELECTRICAL CONNECTION DIAGRAM SADDLE RACK

FRONT VIEW OF PUMP

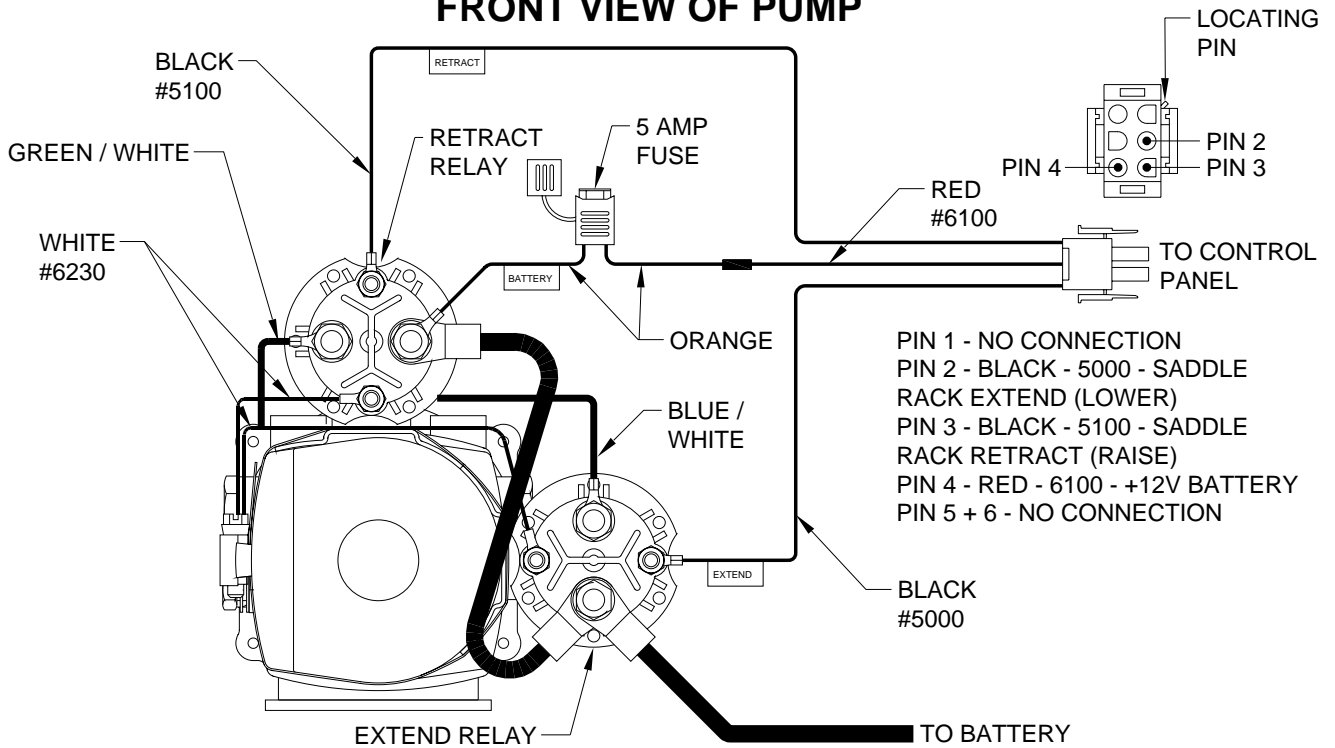

SIDE VIEW OF PUMP

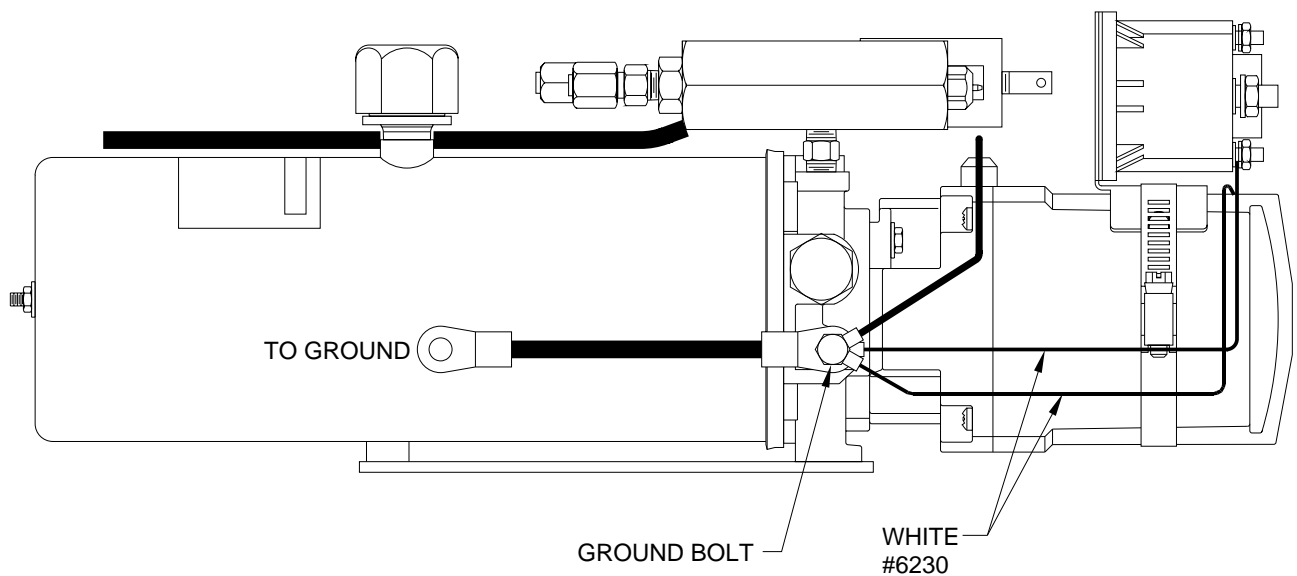

ELECTRICAL CONNECTION DIAGRAM

SADDLE RACK CONTROL PANEL

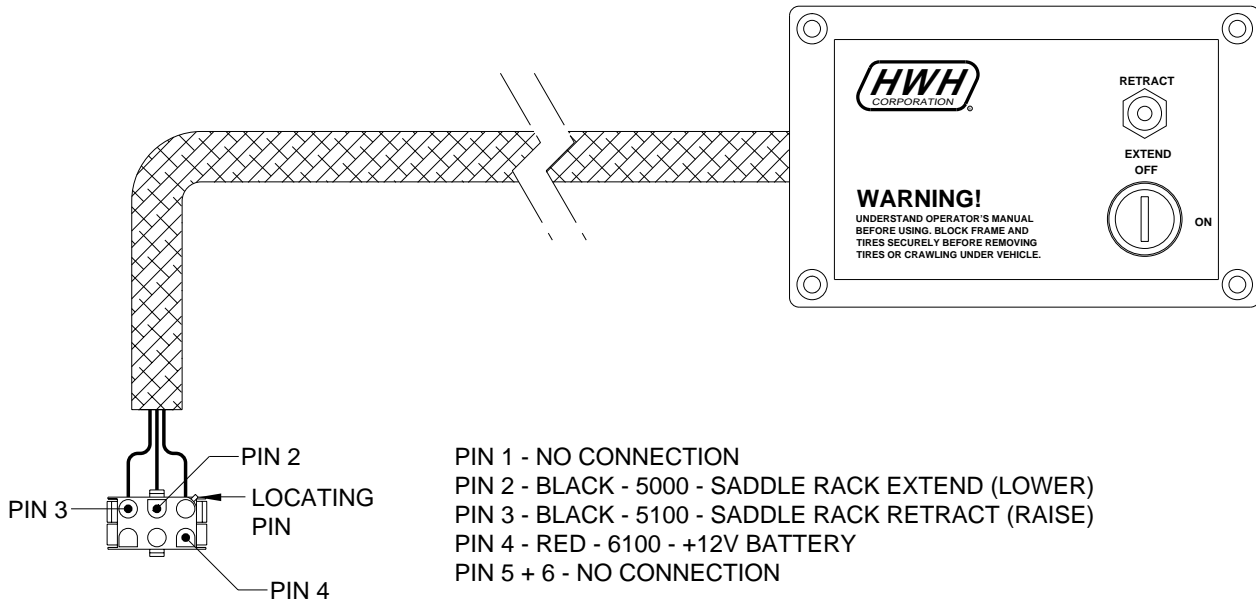

PANEL CONNECTION

