

INSTRUCTION SHEET - JUMPER PLACEMENT FOR 2000 CAN SERIES INSTALLATIONS OR ELECTRONIC SENSING UNIT REPLACEMENT

IMPORTANT: SOME 2000 CAN SERIES ELECTRONIC SENSING UNIT INSTALLATIONS OR REPLACEMENT SITUATIONS ARE PROGRAMMABLE. DURING INSTALLATION OF A SYSTEM OR REPLACEMENT OF AN ELECTRONIC SENSING UNIT DO NOT ASSUME THAT THE SENSING UNIT JUMPERS ARE PRE-SET. THE MOUNTED ORIENTATION OF THE SENSING UNIT ASSEMBLY AND THE SUSPENSION TYPE MUST BE ESTABLISHED IN ORDER TO SET THE JUMPERS AS NEEDED TO PROGRAM THE SENSING UNIT TO THE COACH.

JP1 AND JP2 - CONTROL BOX ORIENTATION (Page 1 of 2)

MOVE JUMPERS JP1 AND JP2 ACCORDING TO THE ORIENTATION OF THE SENSING UNIT. USE THE DRAWINGS PROVIDED TO DETERMINE WHICH APPLICATION IS FOR THE ORIENTATION OF YOUR SENSING UNIT.

FOR SHIPPING PURPOSES THE (4) JUMPERS ARE SLID ONTO ONE SIDE OF JP1 THROUGH JP4. MOVE ONLY THE JUMPERS NEEDED TO DETERMINE ORIENTATION AND SUSPENSION. LEAVING THE REMAINING JUMPERS AS THEY ARE SHIPPED WILL NOT CAUSE PROBLEMS.

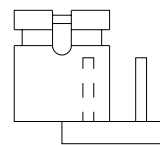
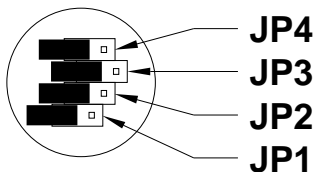

SHIPPED POSITION

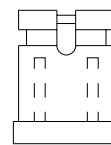

MOVED POSITION

THE FOLLOWING DRAWINGS SHOW THE SENSING UNIT, AS VIEWED WHEN LOOKING DOWN AT THE TOP OF THE SENSING UNIT. REMOVE THE RUBBER RING AND PLASTIC COVER ONLY IF NEEDED. THE RING AND COVER MUST BE REINSTALLED.

FRONT OF VEHICLE

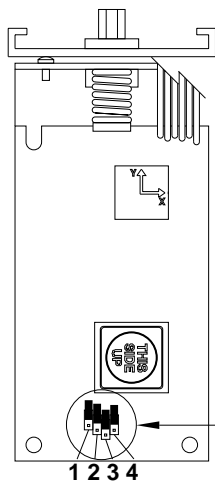

JUMPERS LEAVE JP1 AND JP2 AS SHIPPED

FRONT OF VEHICLE

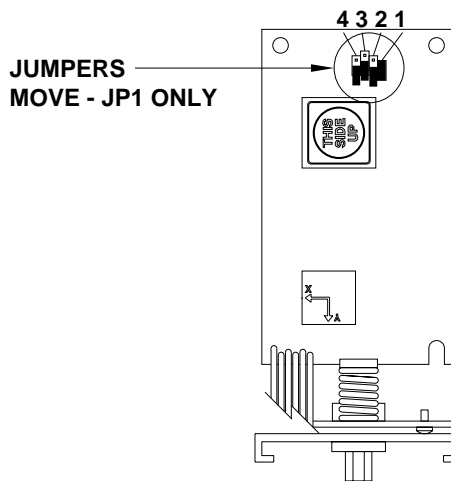

JUMPERS MOVE - JP1 ONLY

FRONT OF VEHICLE

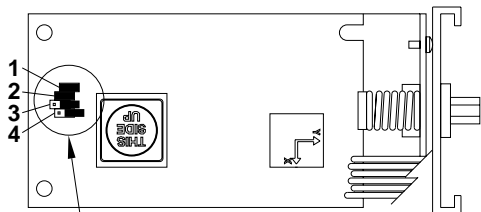

JUMPERS MOVE - JP1 AND JP2

FRONT OF VEHICLE

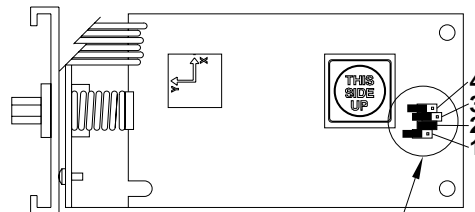

JUMPERS MOVE - JP2 ONLY

NOTE: AFTER MOVING THE JUMPERS, REMOVE AND REAPPLY +12 POWER FOR THE CONTROL BOX. THIS WILL "RE-BOOT" THE SENSING UNIT.

ML50195/MI15.100D
27MAR12

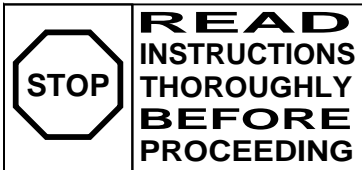

INSTRUCTION SHEET - JUMPER PLACEMENT FOR 2000 CAN SERIES INSTALLATIONS OR ELECTRONIC SENSING UNIT REPLACEMENT

IMPORTANT: SOME 2000 CAN SERIES ELECTRONIC SENSING UNIT INSTALLATIONS OR REPLACEMENT SITUATIONS ARE PROGRAMMABLE. DURING INSTALLATION OF A SYSTEM OR REPLACEMENT OF AN ELECTRONIC SENSING UNIT DO NOT ASSUME THAT THE SENSING UNIT JUMPERS ARE PRE-SET. THE MOUNTED ORIENTATION OF THE SENSING UNIT ASSEMBLY AND THE SUSPENSION TYPE MUST BE ESTABLISHED IN ORDER TO SET THE JUMPERS AS NEEDED TO PROGRAM THE SENSING UNIT TO THE COACH.

JP3 AND JP4 - CONTROL SUSPENSION TYPE (Page 2 of 2)

MOVE JUMPERS JP3 AND JP4 ACCORDING TO THE TYPE OF SUSPENSION ON THE VEHICLE.

NOTE: FOR VEHICLES EQUIPPED WITH COMBINATION SPRING AND AIR SUSPENSIONS USE SPRING SETTINGS.

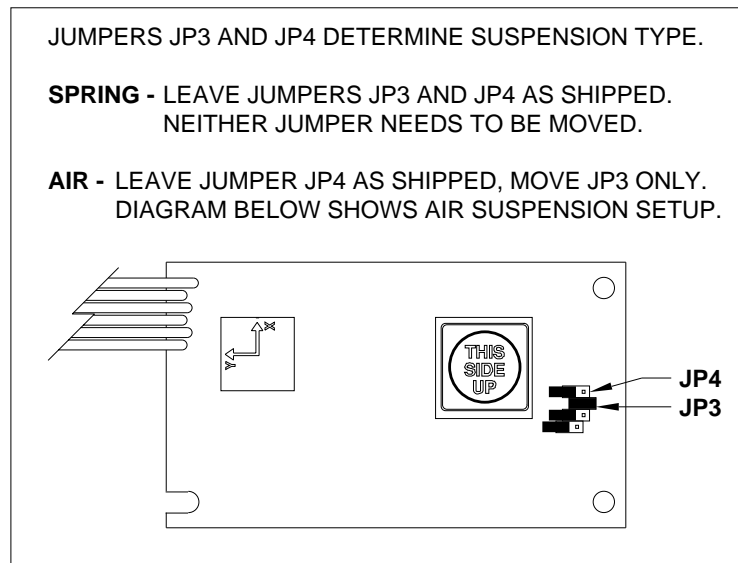

REMOTE LEVEL INDICATOR

SOME 2000 SERIES CONTROL BOXES HAVE A REMOTE INDICATOR BOARD TO AID IN ADJUSTMENT WHEN THE LEVEL SENSOR IS NOT VISIBLE.

THE BOARD IS MOUNTED WITH VELCRO AND SHOULD BE RE-ORIENTED IF NEEDED SO THAT THE GRAY RIBBON CABLE FACES THE FRONT OF THE VEHICLE.

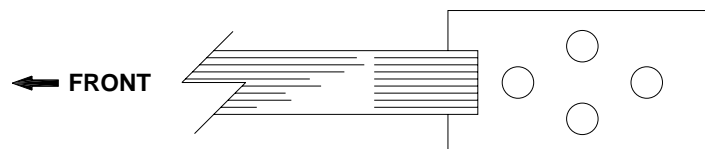

REMOTE LEVEL INDICATOR