



HWH[®] Aftermarket Clamp-On-Jacks for the Ford E350/E450 Cutaway Chassis

HWH[®] AP53802

Easy To Install - No Welding - Clamp On Design

AP53804 Front Jack Kit (Clamp-On) →

Two Straight-Acting (Power-Extend/Spring-Retract) Jacks with a lifting capacity of 4,000 lbs. per jack Standard Profile

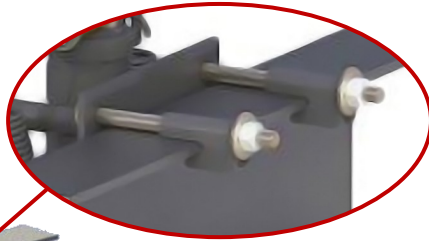

← AP53805 Rear Jack Kit (Clamp-On)

Two Straight-Acting (Power-Extend/Spring-Retract) Jacks with a lifting capacity of 6,000 lbs. per jack on the rear

Automatic leveling for RVs built on the Ford E350/E450 Cutaway Chassis

Owners of RVs built on the Ford E350/E450 Cutaway Chassis can enjoy the benefits of computer-controlled, automatic leveling used for Class A and bus-style RVs. The single-step touch panel is easy to operate. Jacks are specifically designed to clamp on the E350/E450 with no welding or drilling. The front jacks are very compact with a long 13" stroke.

Single-Step Leveling



**Exclusive HWH[®] 4-Point
BI-AXIS[®] Leveling**



Improving Your RV Experience 1967

2096 Moscow Road, Moscow, IA 52760 | Phone: 800-321-3494 | Fax: 563-724-3408 | www.HWH.com